

Product Information

DT16 Series 2-Wire Indoor Monitor



DESCRIPTION

2-wire system 3.5 inch color TFT Monitor

DIMENSION

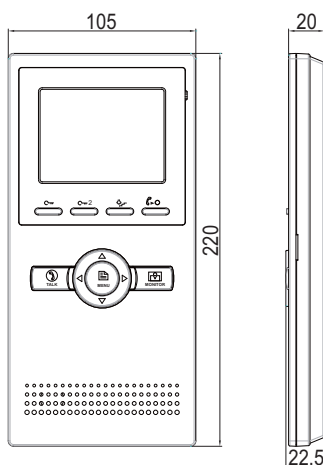

FEATURES

- *1 Plastic housing or Plastic housing with aluminum front panel;
 - ▶ Streamlined & thin design with 20mm thickness only;
 - ▶ Text menu;
 - ▶ 12pcs 8-chord Melodies for choose freely;
 - ▶ Compatible with all DT outdoor & Indoor stations ;
 - *1 Multi languages and remote controller operation(customized);
 - *1 Depends on models
-

1. Parts and Functions

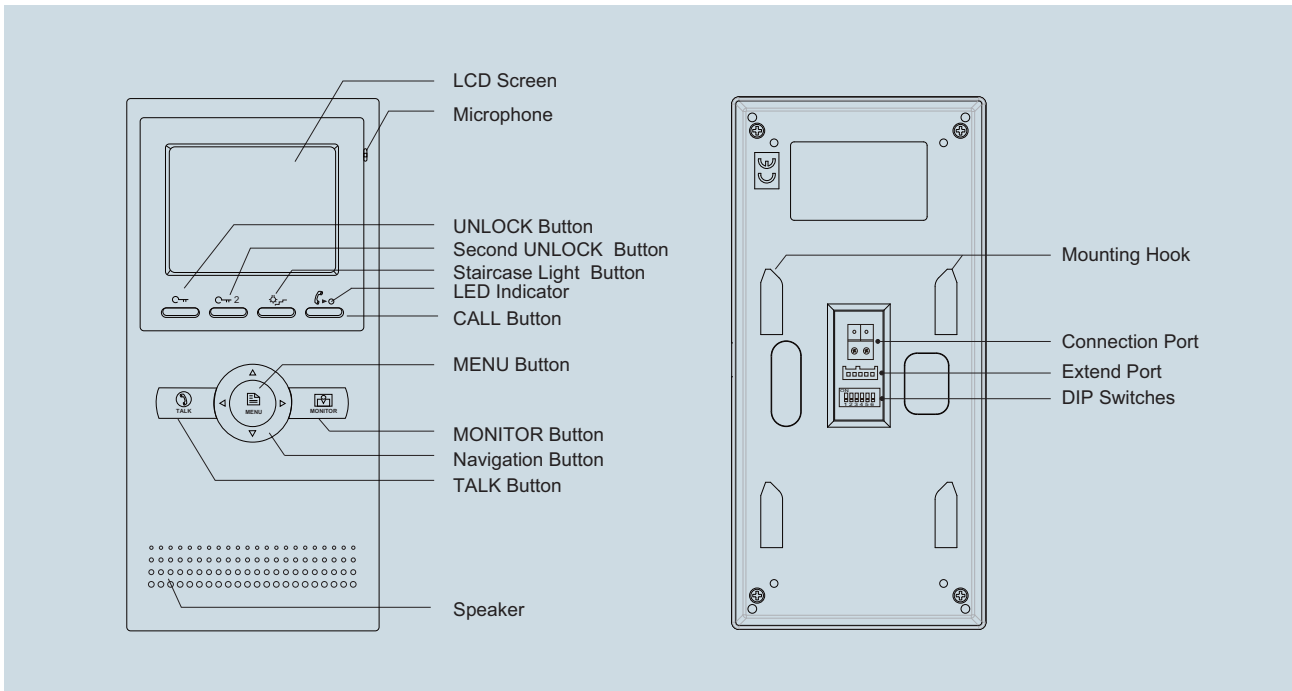

2. Monitor Mounting

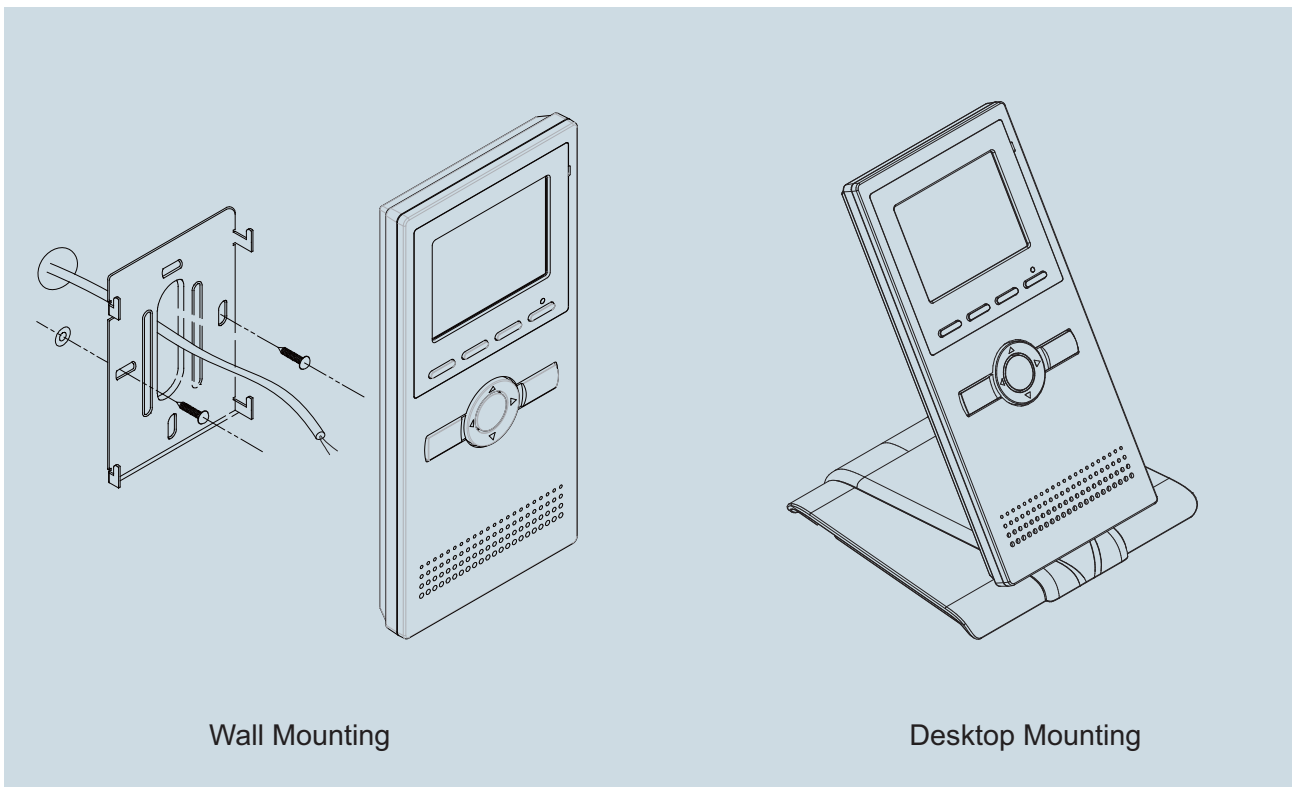

3. Specification

- * Power Supply : DC 24V (supplied by PS4-24V or PS5-24V);
- * Power Consumption: Standby 15mA; Working status 200mA;
- * Display Device: 3.5 inch Digital TFT screen;
- * Resolution: 320 x 240 pixels;
- * Wiring: 2 wires (non-polarity);
- * Monitor Dimension: 220(H)×105(W)×20(D)mm

4. Ordering Information for Monitor

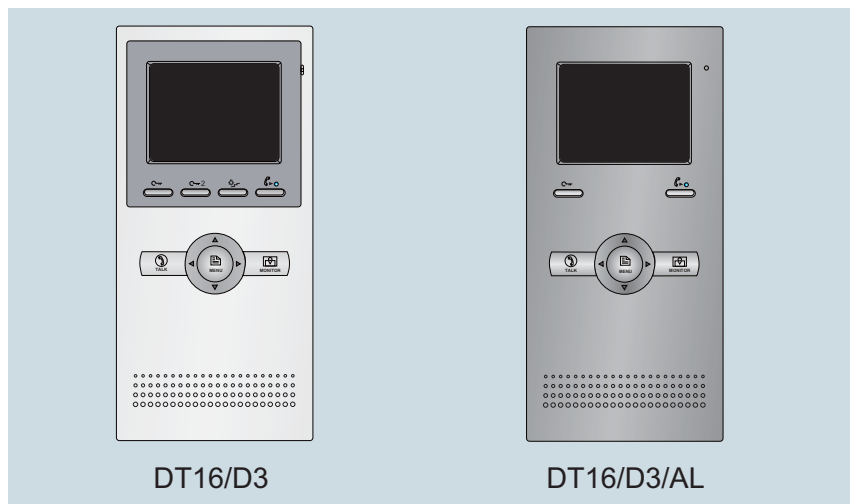

Model No.	Brief Description	Menu Style
DT16/D3	3.5 inch digital color TFT screen monitor with white housing	Text menu
DT16/D3/AL	3.5 inch digital color TFT Screen monitor with aluminum front panel	

5. Optional Accessories (Not included)

Item	Brief Description	Remark
DB1-W	Desk top bracket in white color	For desktop mounting
DB1-B	Desk top bracket in black color	For desktop mounting

6. Packing Information



Dimensions: 249(H)×113(W)×37(D)mm
Gross Weight: 0.39Kg(0.49KG for DT16/D3/AL)

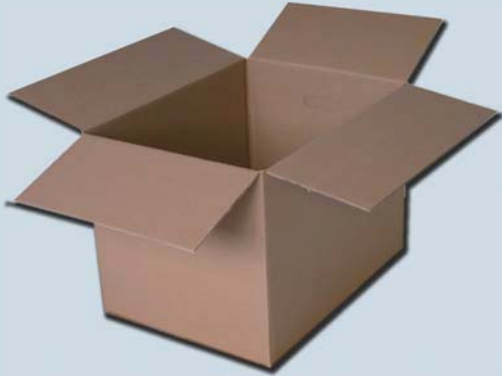

Carton: 530 (H)×340 (W)×258 (D)mm
Quantity: 36PCS

7. App: Menu style

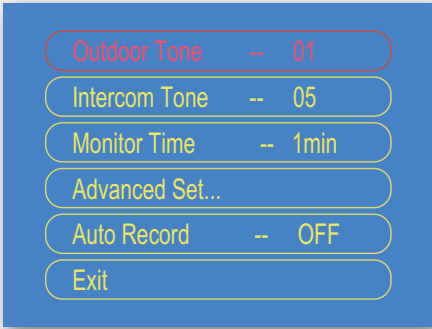

Text Menu Style